

PRODUCT CATALOG



¡NEW PRODUCT!
PANELTEC
PanelC



LAMITEC

Galvanized steel stamp panel gauge 22

Exact depth in the stamp and measures, which allow perfection in the design, in relation to the optimum rigidity and resistance of the material.

Compatibility between all models **without the need for welding**, by the function of the Lamiclick patented system.

Available in Zintro Steel.



*Zintro Steel with a G60 galvanized coating, can be painted without primer.

Ideal material to fabricate doors, doorways, cabinet and gates.

Perfect material in residential and commercial construction projects.



3

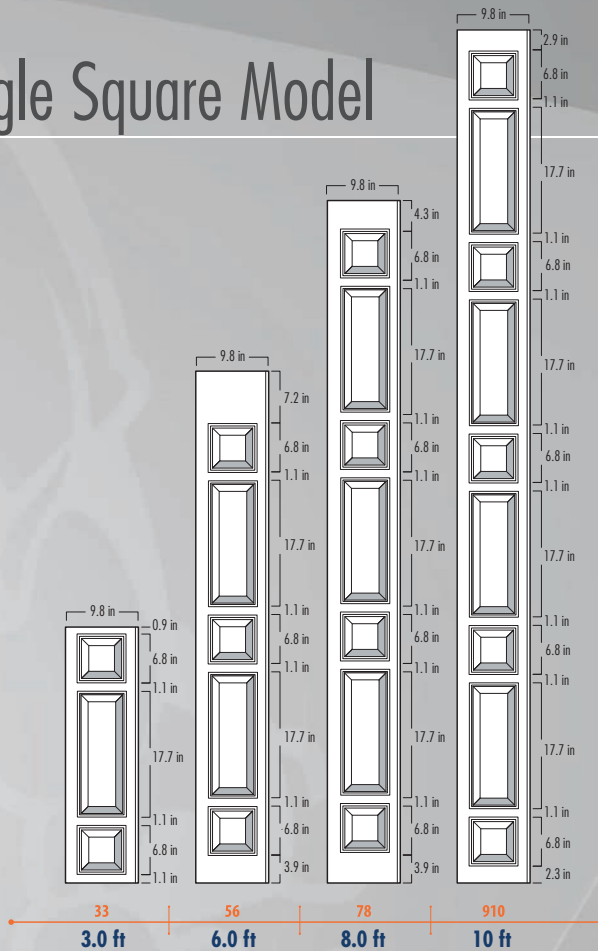



LAMITEC





LAMITEC



PANELTEC

Classic flat **surface design.**

Galvanized Steel Panel **Gauge 22.**

Compatibility for interleaving between all LAMITEC models
without the need for welding, by the function of the Lamiclick patented system.

*Galvanized Steel with a G60 galvanized coating, **can be painted without primer.**

Ideal material to fabricate doors,
doorways, cabinet and gates.

Perfect material in residential and commercial
construction projects.



Paneltec Models

Width

| | Long | 10 ft |
|---|--------|-----------|
| Width | | |
|  0.7 in | 0.7 in | DT20-100 |
|  4.9 in | 4.9 in | DT125-100 |



Possibility of design
with both sides
(front and back)







Watch our video
on **YouTube**

ASSEMBLE YOUR PANEL IN 3 SIMPLE STEPS



LAMICLICK technology is a system of assembly between our panels in an extremely easy and clean way, **without the need of welding.**

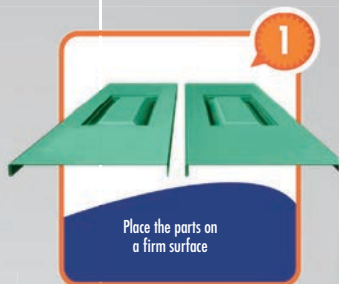

Place the parts on
a firm surface

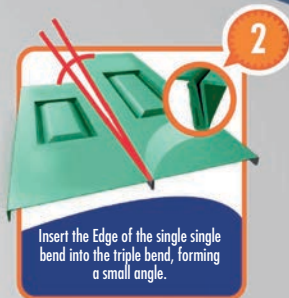

Insert the Edge of the single bend into the triple bend, forming a small angle.



Press carefully along the assembly and this is where the Lamiclick technology comes into action, replacing the welding.

Alternative

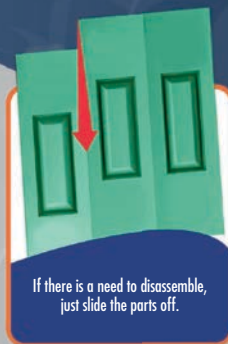

If there is a need to disassemble, just slide the parts off.

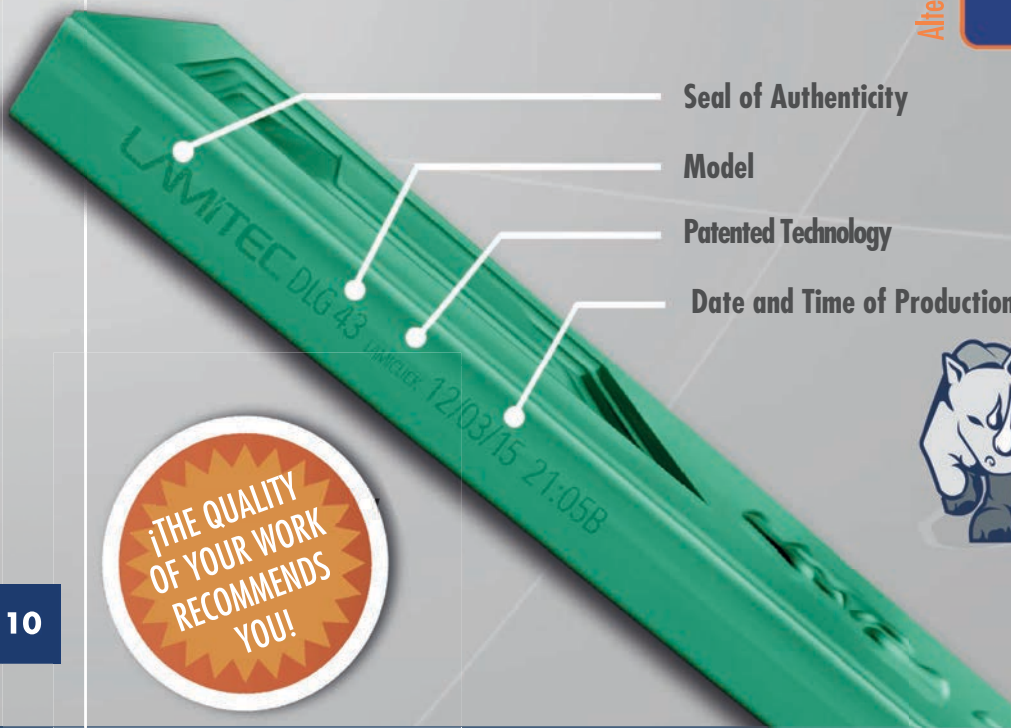

Seal of Authenticity

Model

Patented Technology

Date and Time of Production

THE QUALITY
OF YOUR WORK
RECOMMENDS
YOU!



PANELTEC Panel C

NEW PRODUCT

With Panel C your indoor and outdoor projects will never be the same again.

- Ideal for covering your facades, roof garden or dividing walls.
- Galvanized steel panel gauge 22, with coated textured Wood finish, available in oak, walnut and white oak.
- Maintenance free

USE WITH
LAMIGLUE



Panel C

Walnut



DUELA C 100-305TN

Oak



DUELA C 100-305TR

White Oak



DUELA C 100-305TRB

Transverse View

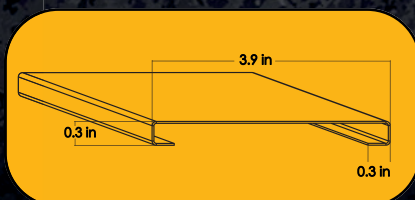

PANELTEC

Panel C

With our trim and angles you can give a perfect finish to your projects with Panel C, with a length of 10 ft.

For the junction between Panel C use
Two Elegance Angles

Elegance Trim:

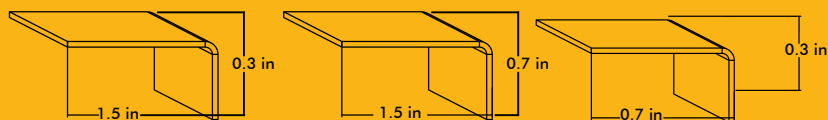

| | Width | Long | 10 ft |
|-----------|------------|------|-------------|
| Walnut | 1.5X0.3 in | | PR41-305TN |
| Oak | | | PR41-305TR |
| White Oak | | | PR41-305TRB |

| | Width | Long | 10 ft |
|-----------|------------|------|-------------|
| Walnut | 1.5X0.7 in | | PR42-305TN |
| Oak | | | PR42-305TR |
| White Oak | | | PR42-305TRB |

| | Width | Long | 10 ft |
|-----------|------------|------|-------------|
| Walnut | 0.7X0.3 in | | PR21-305TN |
| Oak | | | PR21-305TR |
| White Oak | | | PR21-305TRB |

Elegance Angle:

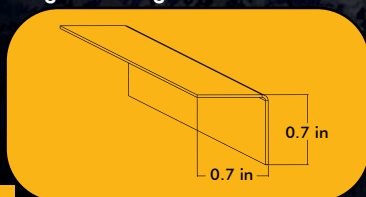

| | Width | Long | 10 ft |
|-----------|------------|------|-------------|
| Walnut | 0.7X0.7 in | | PA22-305TN |
| Oak | | | PA22-305TR |
| White Oak | | | PA22-305TRB |







PANELTEC

PanelU

Meet Panel U, steel panels gauge 22 with wood texture, ideal for the construction of minimalist projects, perfect for indoor and outdoor applications.

- High corrosion resistance
- Wood texture
- High temperature resistance
- Available in Oak, Walnut and White Oak textures
Chocolate and White colors

Perfect for the
construction of
Pergolas!

USE WITH
STEELBOND



Panel U

Available in:
Walnut, Oak and White Oak textures.
Chocolate and White Colors.

Transverse View

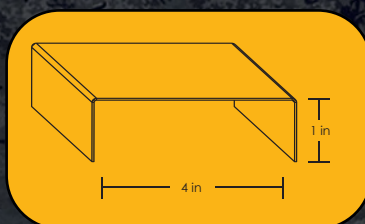

OAK

WALNUT

WHITE OAK

Duela U

Walnut
Oak
White Oak



| |
|--------------------|
| DUELA U 100-305TN |
| DUELA U 100-305TR |
| DUELA U 100-305TRB |







LAMITEC

Elegance

We present our innovative ELEGANCE technology, never seen before in the market, a perfect finish on our traditional panels in **Color and Texture**.

- Galvanized steel panel gauge 22.
- Easy removal of graffiti
(Just wipe with a cloth with thinner)
- Compatibility between Lamitec and Paneltec.
- High corrosion resistance
(Does not destroy the coating).

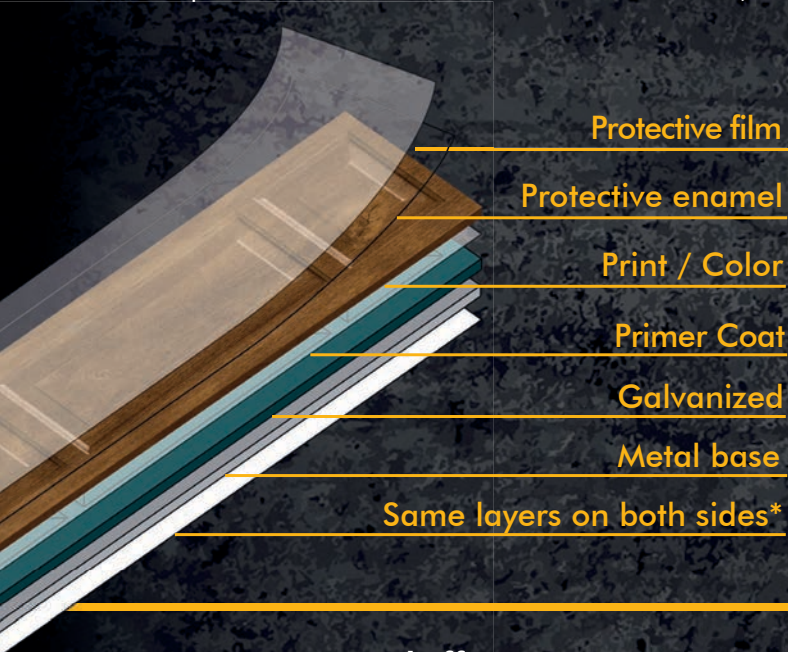

SAVE

TIME AND MONEY

¡Forget about
drying times, primers!

Take advantage and offer your customers a
PERFECT finish in less time.



USE WITH
STEELBOND

Rectangle Square Model

Available in:

Walnut, Oak and
White Oak textures.

OAK
WALNUT
WHITE OAK

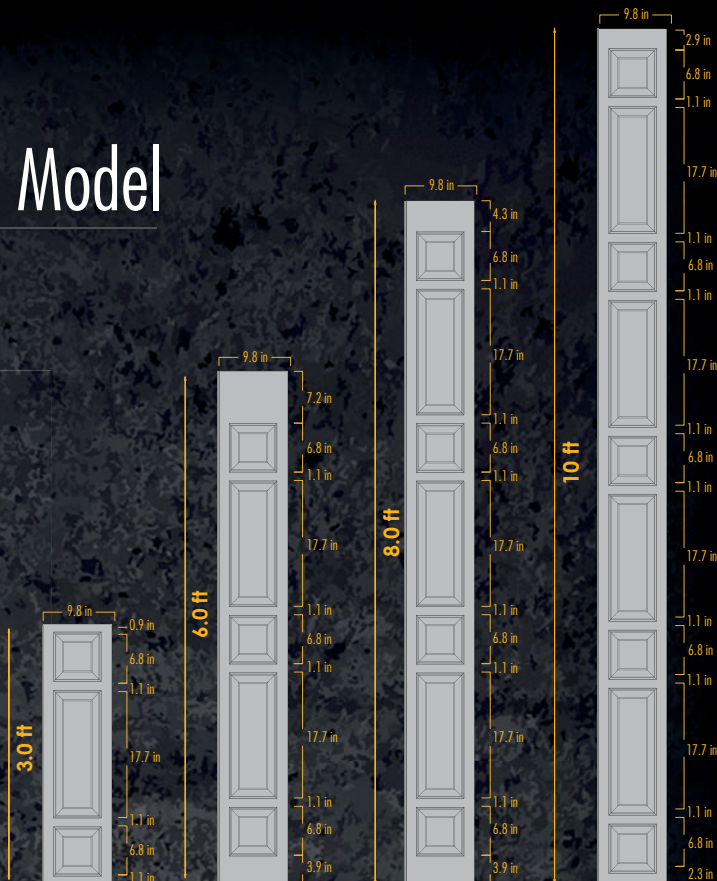

Rectangle Square Model

Oak
Walnut
White Oak

| | | | |
|-------|-------|-------|--------|
| 33TR | 56TR | 78TR | 910TR |
| 33TN | 56TN | 78TN | 910TN |
| 33TRB | 56TRB | 78TRB | 910TRB |

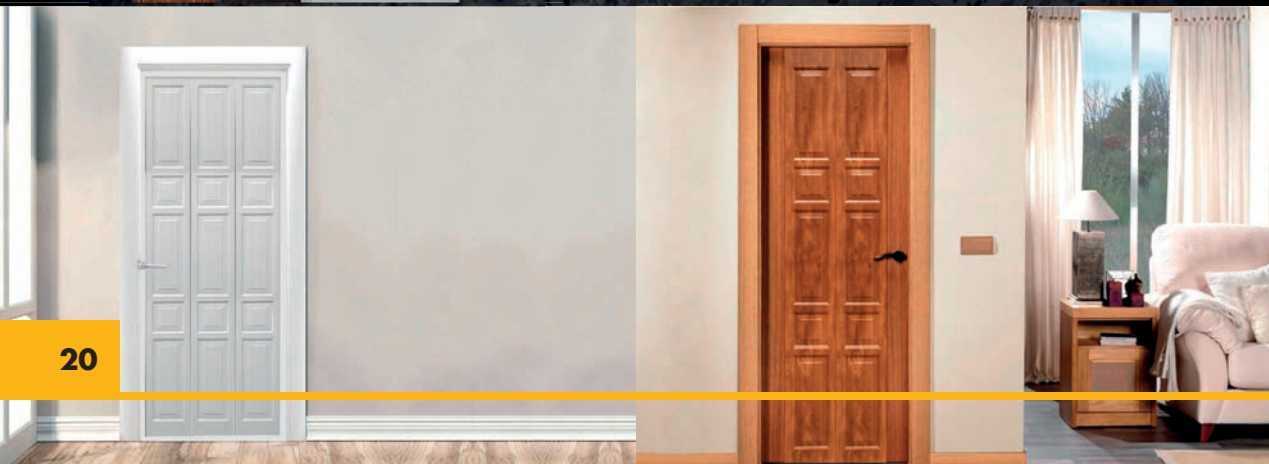



LAMITEC
Elegance









PANELTEC

Elegance

Our traditional flat panel with the perfect wood texture.
Available in Walnut, Oak and White Oak textures.

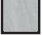
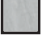
| Width \ Long | | 0.7 in | | 4.9 in | |
|--------------|-----------|---|--------------|---|---------------|
| | | | | | |
| 10 ft | Walnut |  | DT20-100-TN |  | DT125-100-TN |
| | Oak |  | DT20-100-TR |  | DT125-100-TR |
| | White Oak |  | DT20-100-TRB |  | DT125-100-TRB |

Width

0.5 in |  | 0.6 in

0.5 in |  | 0.6 in

WHITE OAK
WALNUT
OAK





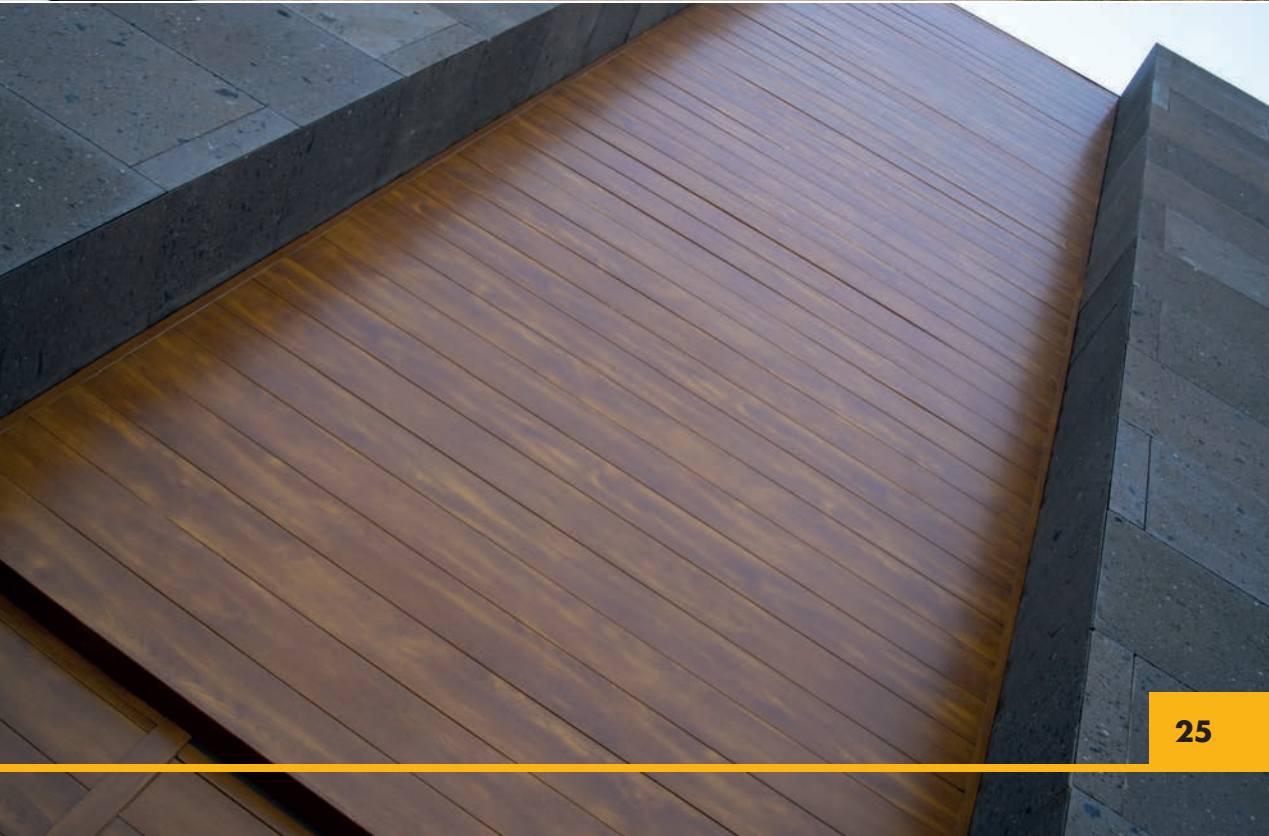

LAMIGLUE

- Perfect for indoor and outdoor use.
- Bonds construction materials.
- Excellent weight-carrying capacity.
- Bond a porcelain, ceramics, skirting boards, bathroom accessories, etc.
- Bond aluminum and other metals.

USE IT WITH



PANELTEC
Panel



Watch our video
on **YouTube**

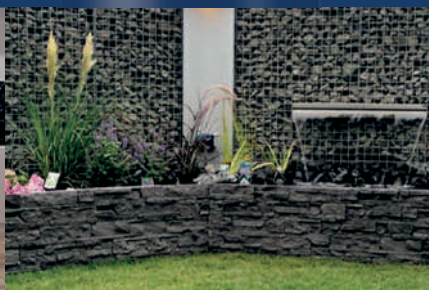
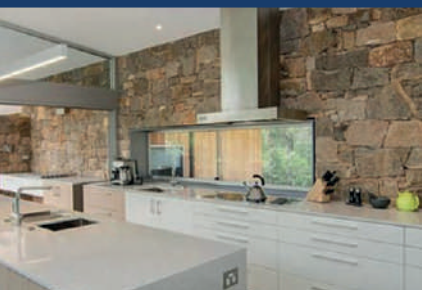

INDUSTRIES



HOME



BUILDING



MARITIME



AUTOMOTIVE



AND MORE...

STEELBOND

Structural acrylic adhesive for all types of metals.

Each adhesive contains 45 ml

Features & Benefits

It works in just 10 minutes!

Maximum strength in 24 hours

Less health risk

No runoff

Works as cold welding

You can bond high surface energy materials

(ABS, polyurethane, polycarbonate, PVC, acrylic, nylon, wood, MDF, metals)



Illustrative photos.

iEasy to apply!

Adhesive strength per square inch

| Surface | lb/in ² |
|-------------------------|--------------------|
| Aluminum | 3399.9 |
| Stainless steel | 3199.9 |
| Polyvinyl chloride | 1800 |
| Acrylonitrile Butadiene | 1299.9 |
| Styrene | 1099.9 |
| Acrylic | 849.9 |
| Polycarbonate | 550 |
| Polystyrene | 799.9 |



1
Clean the bonding area with isopropyl alcohol.



2
Press the trigger to make 5.9in lines at the panels joint.



3
Previously place the assembled panels and press for 10 minutes.

It works in only 10 minutes!

FOLLOW US ON OUR SOCIAL NETWORKS
¡FIND PHOTOS, IDEAS, TUTORIALS AND MORE!



/LamitecGroupUSA

On Sale at:



Free Copy

The trademarks and trade names mentioned in this document are registered or in the process of being registered. Products, processes and technologies protected under pending patents.

See our privacy notice at:

www.lamitecgroup.com